



Full I-405 closure in Renton

Freeway closed July 10 at 2 a.m., opening July 11 at 11 a.m.

What's happening on I-405 in Renton?

WSDOT has built a new Benson Road S. Bridge over I-405 as a part of the Renton State 2 Widening project. WSDOT now needs to remove the old bridge to accommodate new lanes.

For 33 hours during the weekend of July 10, crews will completely close I-405 to safely remove the old bridge. The closure is necessary because traffic cannot pass underneath the bridge while crews tear it down. To maximize progress, crews will also work on several other needed projects in the work zone during the closure.

Where will I-405 close?

Crews will close all lanes in both directions of I-405 between Maple Valley Highway (SR 169) and SR 167 beginning at 2 a.m., on Saturday, July 10. The roadway will reopen by 11 a.m., Sunday, July 11.

How should I prepare for the closure?

- Avoid I-405 by taking alternate routes such as I-5, I-90 and SR 520.
- Allow extra time for travel.
- Travel before 10 a.m. and after 7 p.m.
- Plan ahead and use real-time traffic tools.



Drivers of I-405 will need to observe detours when traveling through Renton the weekend of July 10th.

Tools to keep you moving:

- For real-time construction updates, visit:
www.wsdot.wa.gov/construction/2010/today
- Check the traffic flow maps:
www.wsdot.wa.gov/traffic/seattle
- Dial 5-1-1 for real-time travel information
- Follow us via Twitter
[@wsdot_traffic](https://twitter.com/wsdot_traffic)

For more information:

Steve Peer

I-405 Corridor Program
steve.peer@i405.wsdot.wa.gov
425-456-8624

Kristina Evanoff

I-405 Corridor Design Builders
kristina.evanoff@ch2m.com
425-496-2037

I-405 Construction Hotline

425-456-8585

Closure website

<http://www.wsdot.wa.gov/Projects/I405/SR515Interchange/closure.htm>



167

How to get around the closure

During the closure, drivers should plan ahead by avoiding the area or taking alternate routes. Drivers should expect heavy traffic on the detour routes. Delays and backups are expected in Renton and throughout the Puget Sound region.

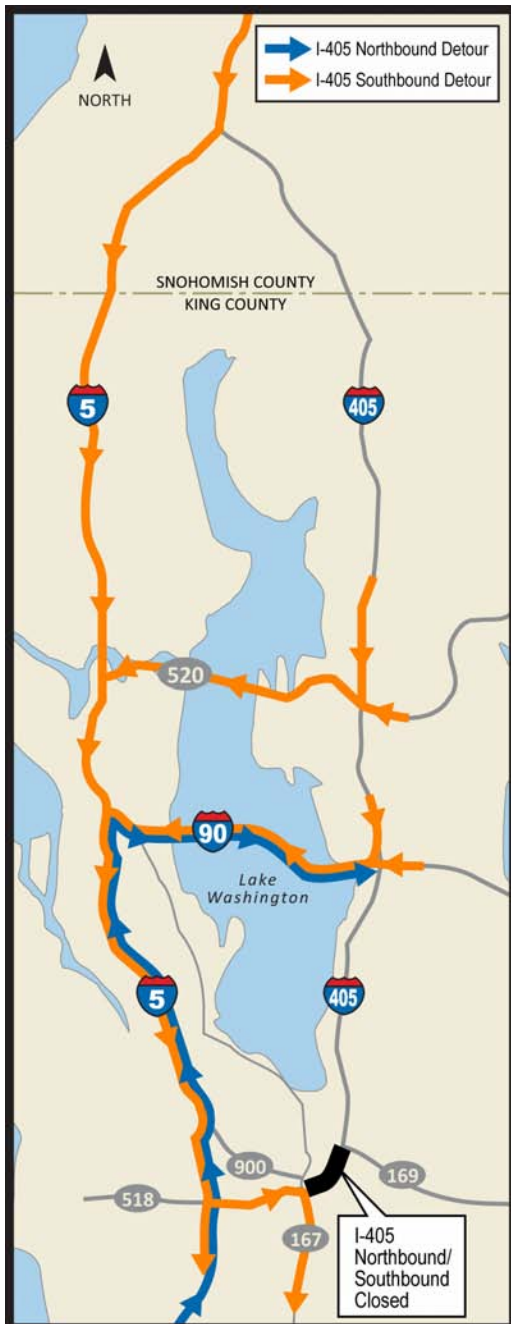

Recommended Regional Detour:
Drivers should use I-5, SR 520, and I-90

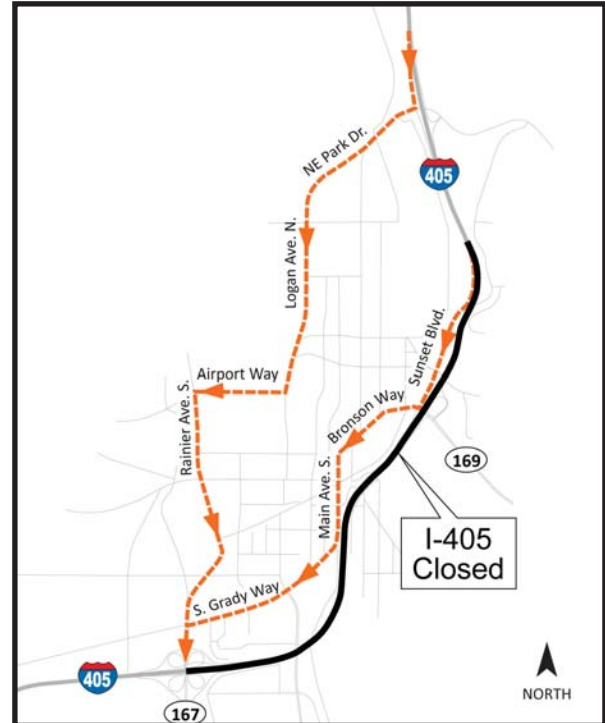

Local Southbound I-405 Detour

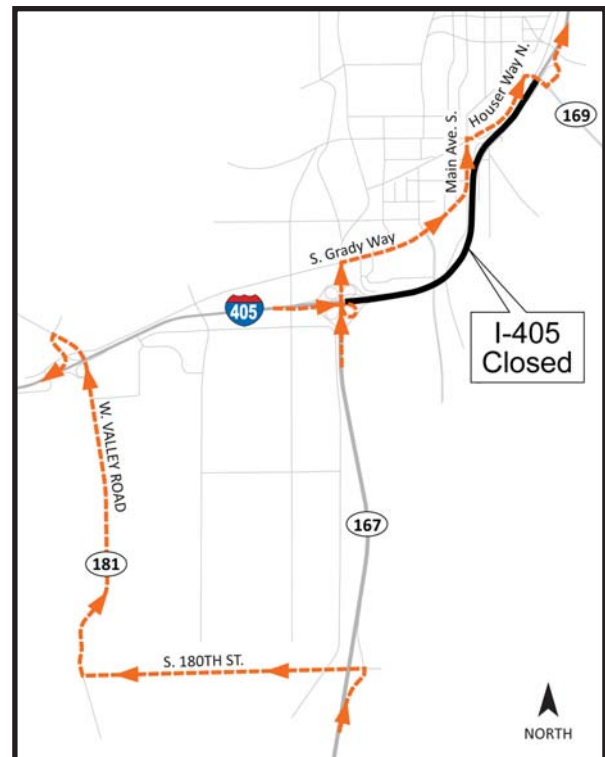

Local Northbound I-405 Detour